

MICRO-BAR

PERMANENT MOUNT



RED: To +VDC (fuse @ 8A)

BLACK: To Chassis Ground (-)

BLUE: Flash patterns & Synchronization

- Momentarily apply +VDC to BLUE for Flash Pattern change
- Continuously apply +VDC to BLUE for Low Power
- Connect BLUE wires of all minibars together for synchronization; all units must be set at the same pattern

WARNING:

Do not look directly into LEDs while in operation; may cause momentary blindness and/or eye damage.

FLASH PATTERNS

Momentarily apply +VDC to **BLUE:**

- Once for next pattern
- Quickly 3 times for reset to FP#0

FP#	Flash Patterns
0	Random
1	Rotating
2	Single (split)
3	Double (split)
4	Quad (split)
5	Quint (split)
6	Mega (split)
7	Ultra (split)
8	Single-Quad (split)
9	Single H/L (split)
10	Single (all)
11	Double (all)
12	Quad (all)
13	Quint (all)
14	Mega (all)
15	Ultra (all)
16	Single-Quad (all)
17	Single H/L (all)
18	Steady Half
19	Single (2Hz)
20	Double (2Hz)
21	Triple (2Hz)
22	Quad (2Hz)

4-BOLT MOUNT BRACKETS

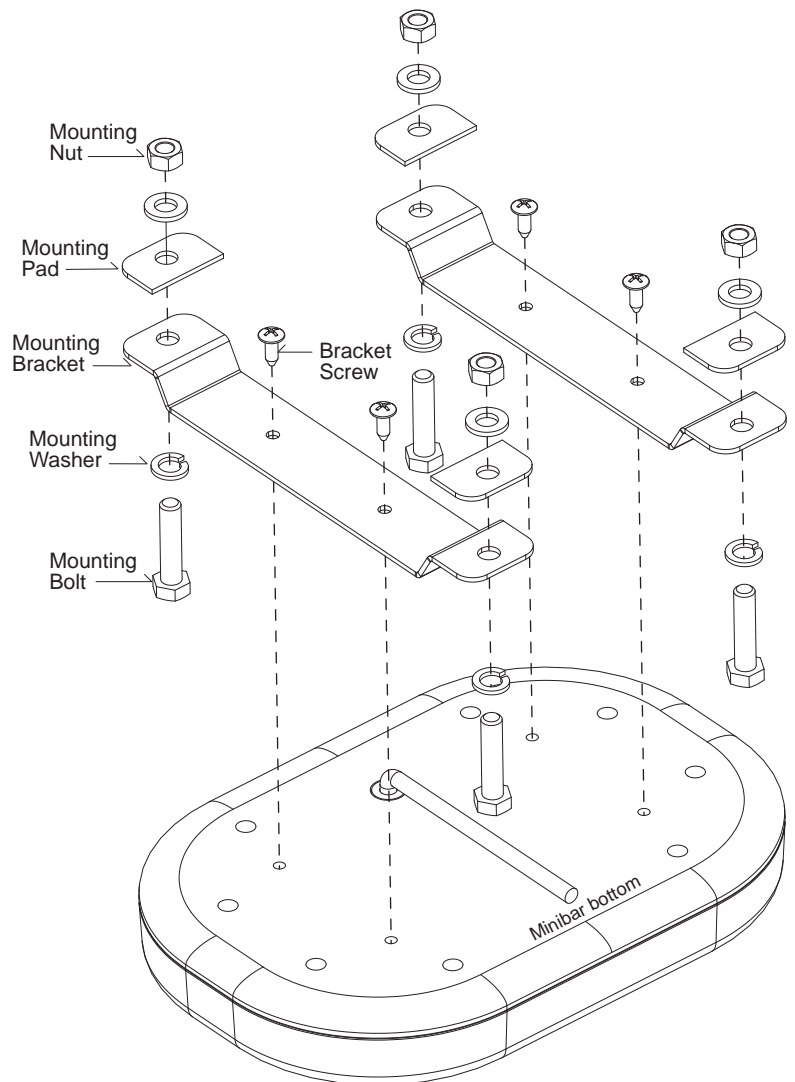

Note: This unit may not be factory set at FP#0



Model: with Dual button cigar-plug.



WARNING:

It is not recommended to use magnetically mounted warning devices on vehicles in motion. Usage is at the sole risk and responsibility of the user.

FLASH PATTERNS

Momentarily push flash pattern button:

- Once for next pattern
- Quickly 3 times for reset to FP#0

FP#	Flash Patterns
0	Random
1	Rotating
2	Single (split)
3	Double (split)
4	Quad (split)
5	Quint (split)
6	Mega (split)
7	Ultra (split)
8	Single-Quad (split)
9	Single H/L (split)
10	Single (all)
11	Double (all)
12	Quad (all)
13	Quint (all)
14	Mega (all)
15	Ultra (all)
16	Single-Quad (all)
17	Single H/L (all)
18	Steady Half
19	Single (2Hz)
20	Double (2Hz)
21	Triple (2Hz)
22	Quad (2Hz)

MAGNET MOUNT

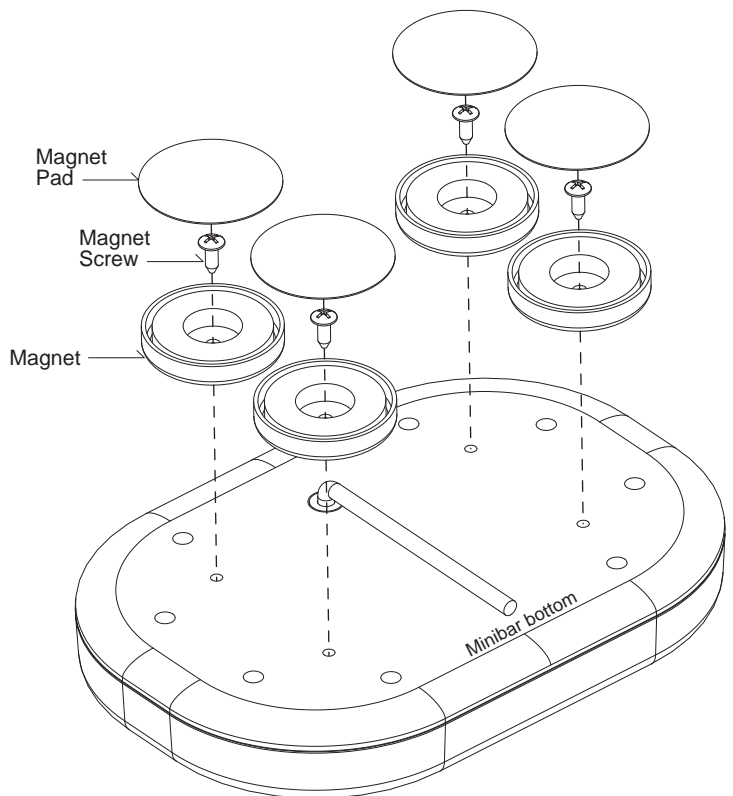

Note: This unit may not be factory set at FP#0